



LAMP LED 2*3*4MM



Packing: anti-static bag, 1000/bag

viewing angle: Lambertian Emitter (30-110°)

Welding: IR Reflow Soldering Profile for lead free soldering, 260°C±5°C for 3 -5seconds. Wave soldering lead-free soldering 260°C±5°C for 3 -5seconds. Manual lead-free soldering 360°C±5°C for 2-3 seconds.

Package Outlines

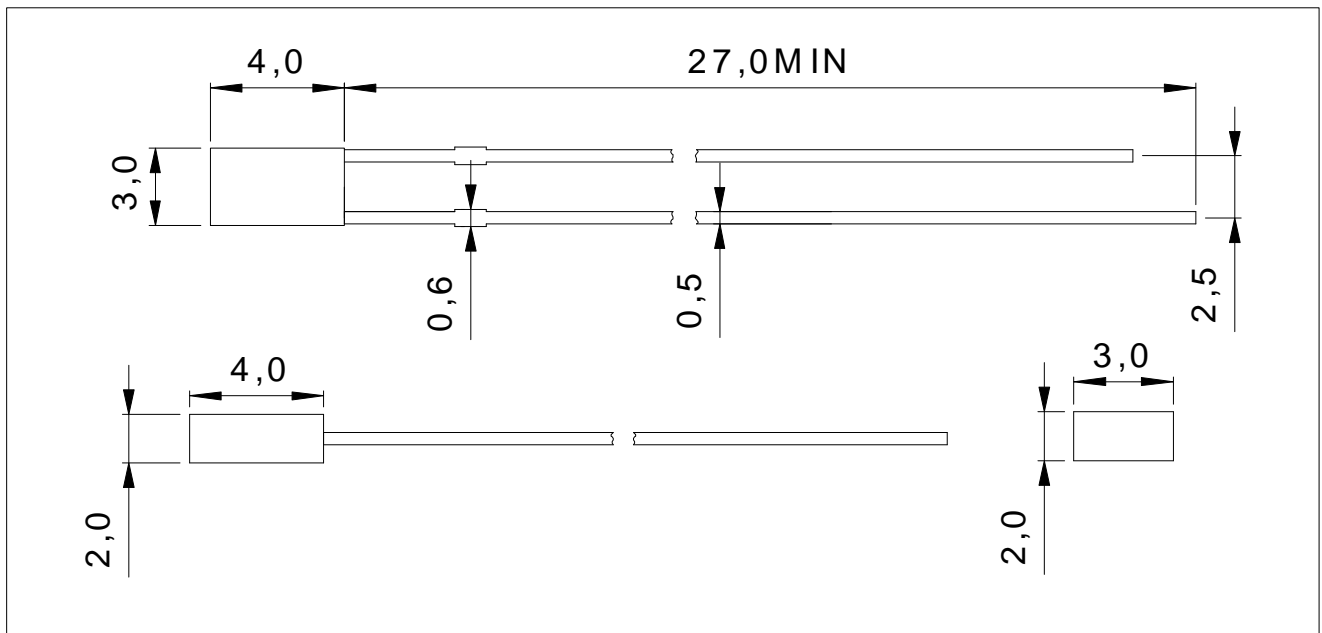

Note: 1. All dimensions are in millimeters (inches).
2. Tolerance is ±0.1mm unless otherwise noted.

Ordering Information

Type	Color of Emission	Adaptation current	Brightness Group	Wavelength
2*3*4MM LAMP	White	$I_F = 20mA$	X0.30/Y0.30	600-8200mcd
2*3*4MM LAMP	Red	$I_F = 20mA$	615-645nm	120-1600mcd
2*3*4MM LAMP	Yellow	$I_F = 20mA$	586-592nm	100-1400mcd
2*3*4MM LAMP	Yellow Green	$I_F = 20mA$	565-576nm	16-500mcd
2*3*4MM LAMP	True Green	$I_F = 20mA$	515-525nm	450-6800mcd
2*3*4MM LAMP	Blue	$I_F = 20mA$	460-475nm	100-1400mcd

Note: Please contact the salesman for detailed specifications!